

# The Country Club of Virginia

## Westhampton Clubhouse

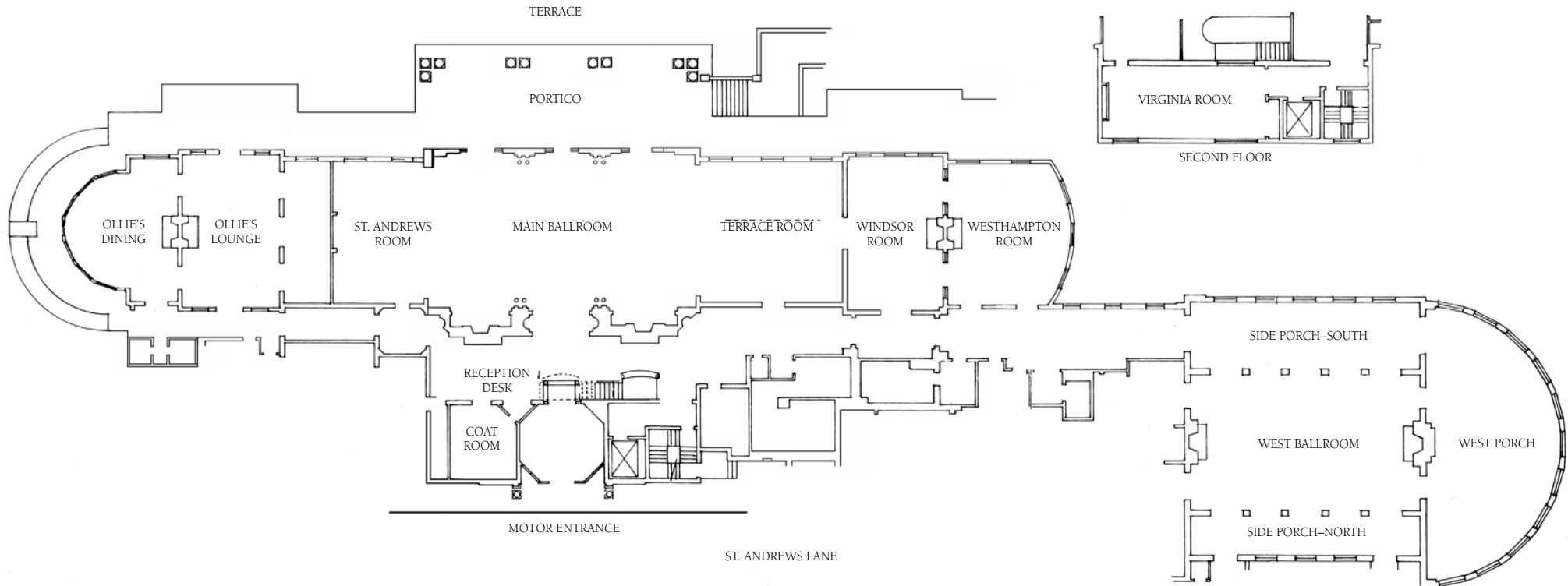

**Ollie's Dining Room**

19' 8" x 31' 9"  
Seated: 36  
Reception: 40

**St. Andrews Room**

19' 8" x 31' 9"  
Seated: 60  
Reception: 40

**Terrace Room**

32' 2" x 32' 2"  
Seated: 90  
Reception: 75

**Westhampton Room**

28' 7" x 32' 2"  
Seated: 70  
Reception: 75

**West Ballroom**

53' 2" x 29' 6"  
Seated: 120  
Reception: 175  
Reception Including West Porch: 250

**Virginia Room**

35' 11½" x 17' 4"  
Conference Table for 19

**Ollie's Lounge**

60' 2" x 35' 5½"  
Seated: 32  
Reception: 35

**Main Ballroom**

60' 2" x 35' 5½"  
Seated: 120  
Reception: 125

**Windsor Room**

22' 2" x 34' 10"  
Seated: 50  
Reception: 65

**Side Porch-South**

15' 10½" wide

**West Porch**

29' 6" x 59'  
Seated: 90  
Reception: 75

**Side Porch-North**

9' 10½" wide

**Portico**

56' x 17' 5"